



1004/180 Morphett Street Adelaide SA

1 1

This sleek and stylish studio is a chic, convenient and comfortable means to expanding your property portfolio or stepping onto the real estate ladder. Located in the sought-after 'Vision' complex in the heart of the Adelaide CBD, savvy investors will need to be quick because this one won't be on the market long.

2.7-metre high ceilings and an open-plan design make the 58-square-metre floorplan feel ample if not abundant, enhanced by the natural light pouring in through the glass balcony doors. Panoramic views across Light Square are breath-taking no matter the time of day - the perfect backdrop to your new urban lifestyle.

Other features we love about this unit include:

- Reverse cycle air-conditioning throughout.
- Gourmet kitchen with stainless steel appliances including

Price : \$ 300,000

View : <https://www.sinova.com.au/sale/sa/adelaide/adelaide/residential/apartment/6655285>



Doris He
0423 707 585



Stephen Ong
08 7080 5884

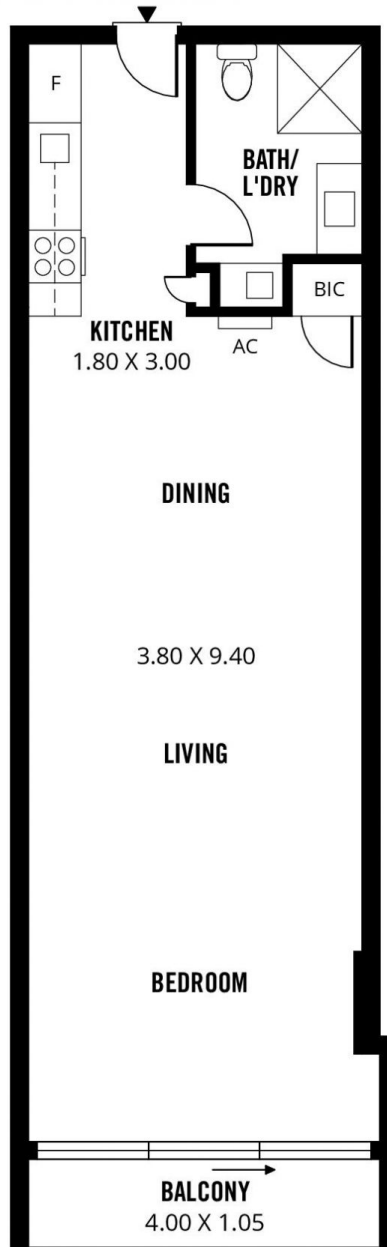

58m²

TOTAL



54m²

Living



4m²

Balcony



Scale in metres. This drawing is for illustration purposes only. All measurements are approximate and details intended to be relied upon should be independently verified.

Produced by **The Fotobase Group**