

38/44 Glynburn Road Hectorville SA

2 1 1

*** NO registration is required for public open inspections

How to apply: If you wish to apply for this property, Please apply through www.1form.com.au and send your application to info@sinova.com.au

Furniture - Unfurnished
Lease Term - 12 months to start with
Bond - 6 Weeks rent equivalent
Water Charges - Water supply only (water use cost included in the rent)
Available from : NOW

View : <https://www.sinova.com.au/lease/sa/eastern-suburbs/hectorville/residential/townhouse/6906275>



Maggie Du
08 7080 5884



Vivi Zhao
08 7080 5884

Close proximity to local shopping, public transport practically on your door step and not too far from the CBD

<https://www.sinova.com.au>

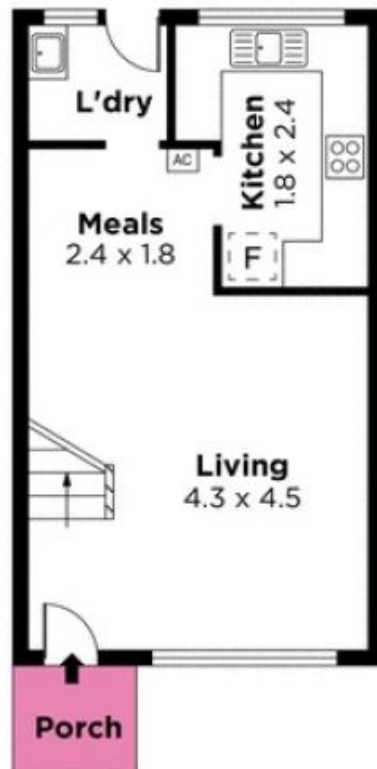
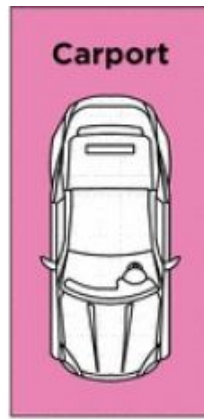

Lower Level

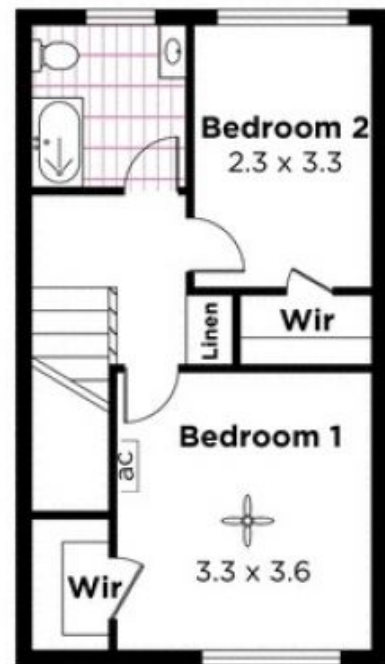

Upper Level

Area (Estimate only)	
Internal	72m ²
Carport	14m ²
Total	86m ²