

## 20 Alton Avenue Magill SA

4 2 2

This north-facing home steps outside the box, forging its own path and setting new benchmarks. If you're looking for incomparable family living just 15-minutes from the CBD, this unique offering is definitely worth checking out.

Upon arrival at the approx. 807sqm property a well-tended front yard with extra wide frontage greets you. The homely façade has an eye-catching mix of exposed brick and render seamlessly blending in with the tiled roof. A brick-paved driveway leads to the double lock up garage, while a covered front porch invites you indoors.

High ceilings and an expansive hallway create a feeling of spatial excess upon entry. The outstanding features in the home are immediately evident, and these are some that we love:

- The wide hallway leads to the open-plan kitchen, family

**Price** : \$ 1,405,000  
**Land Size** : 807 sqm  
**View** : <https://www.sinova.com.au/sale/sa/eastern-suburbs/magill/residential/house/7270305>



**Stephen Ong**  
08 7080 5884



**David Deng**  
08 7080 5884

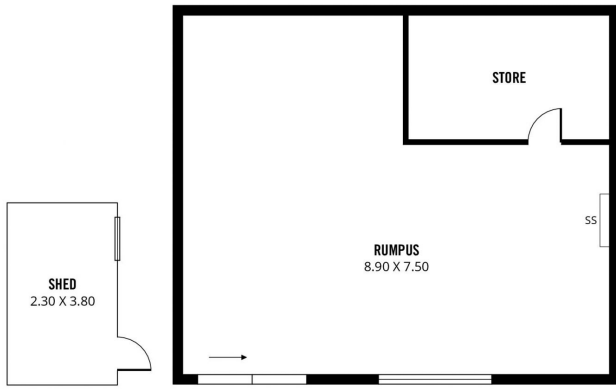

TOTAL

Living

Shed

Garage

Porch/  
Pergola

Outdoor  
Entertaining



Scale in metres. This drawing is for illustration purposes only. All measurements are approximate and details intended to be relied upon should be independently verified.

Produced by The Fotobase Group