



7/333 Fullarton Road Parkside SA

2 1 1

Introducing a Spacious 2 Bedroom Unit in the Heart of Parkside

Nestled in the heart of Parkside, just a stone's throw from the city's vibrant center, this spacious two-bedroom unit offers an ideal blend of comfort and convenience. Boasting an open-plan kitchen, meals, and living area with inviting floating floors, this residence exudes a welcoming atmosphere from the moment you step inside.

Key Features:

- The roomy, open-plan kitchen and living area provide the perfect setting for relaxation and entertainment.
- The kitchen is equipped with ample cupboard and bench space and features a gas cooktop, catering to all your culinary needs.
- Two large bedrooms offer a haven of tranquility. One of

Price : \$ 395,000
Building Size : 66 sqm
View : <https://www.sinova.com.au/sale/sa/eastern-suburbs/parkside/residential/unit/7817182>



Stephen Ong
08 7080 5884



Felix Chu
08 7080 5884

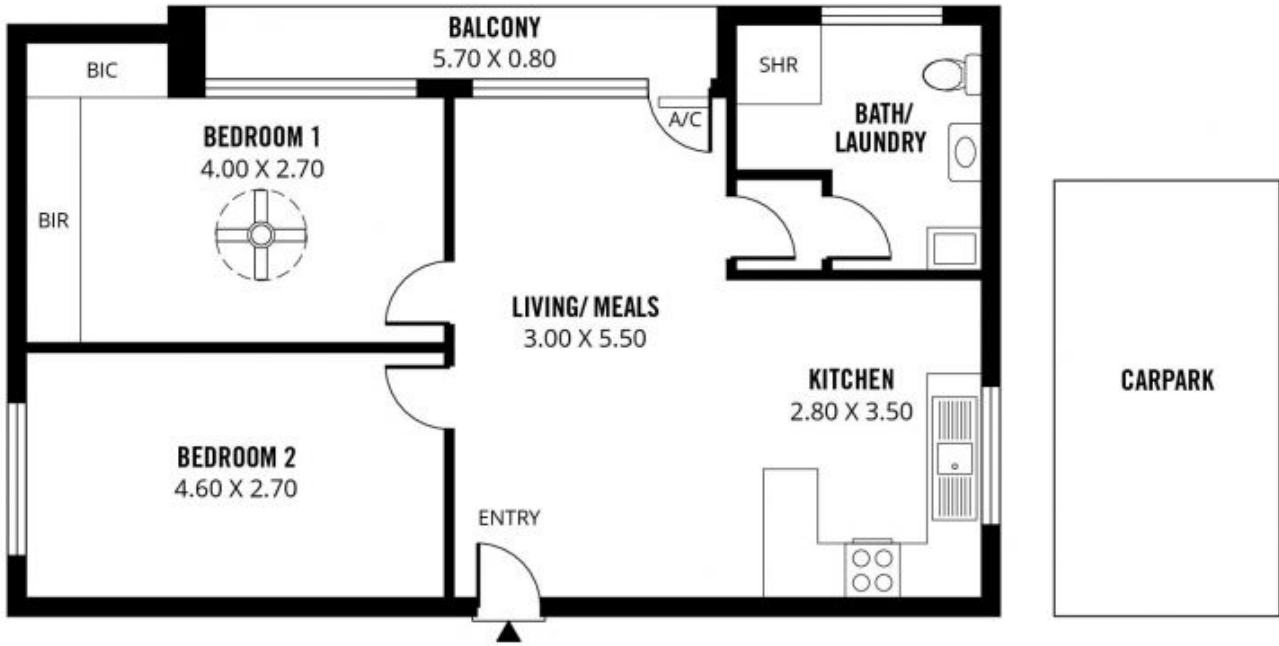

85m²

TOTAL



68m²

Living



5m²

Balcony



12m²

Carpark



Scale in metres. This drawing is for illustration purposes only. All measurements are approximate and details intended to be relied upon should be independently verified. Produced by **The Fotobase Group**