



6A Sycamore Terrace Campbelltown SA

3 2 1

This Torrens titled townhouse showcases an exemplary commitment to thoughtful design. The three-bedroom, two-bathroom residence seamlessly integrates nice finishes with a spacious layout and an air of sophisticated elegance, representing a truly forward-thinking home.

This townhouse will transform your expectations of townhouse living. Its clean lines and sophisticated combination of brick, rendering, and expansive windows significantly enhance its street appeal, further highlighted by the striking 2.4-meter timber front door. The property includes a single car-remote garage with a luxurious acrylic glass door, complemented by an additional parking space on the driveway.

Type : Townhouse
Price : \$819k - \$839k
Building Size : 213 sqm
Land Size : 200 sqm
View : <https://www.sinova.com.au/sale/sa/north-north-east-suburbs/campbelltown/residential/townhouse/8125370>



Stephen Ong
08 7999 5884



David Deng
08 7999 5884

[For full version visit the website](https://www.sinova.com.au)

<https://www.sinova.com.au>

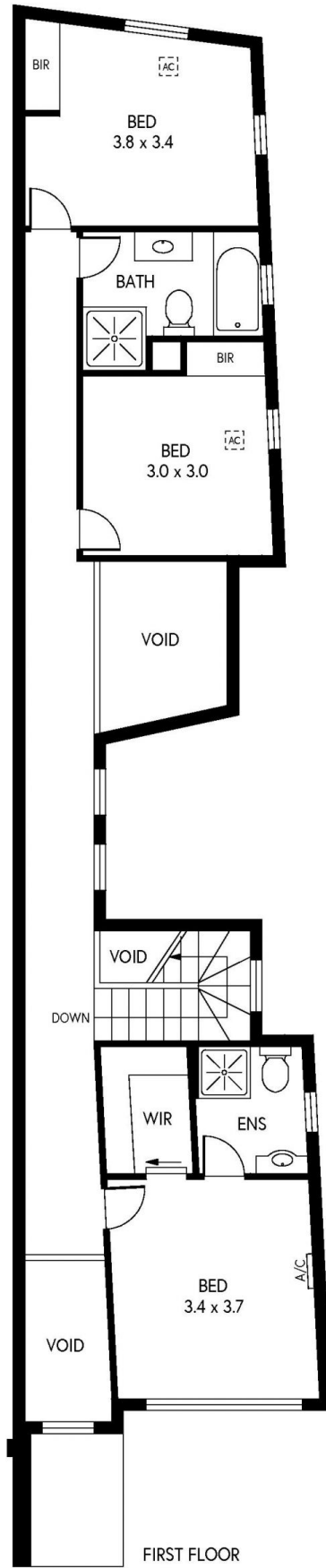
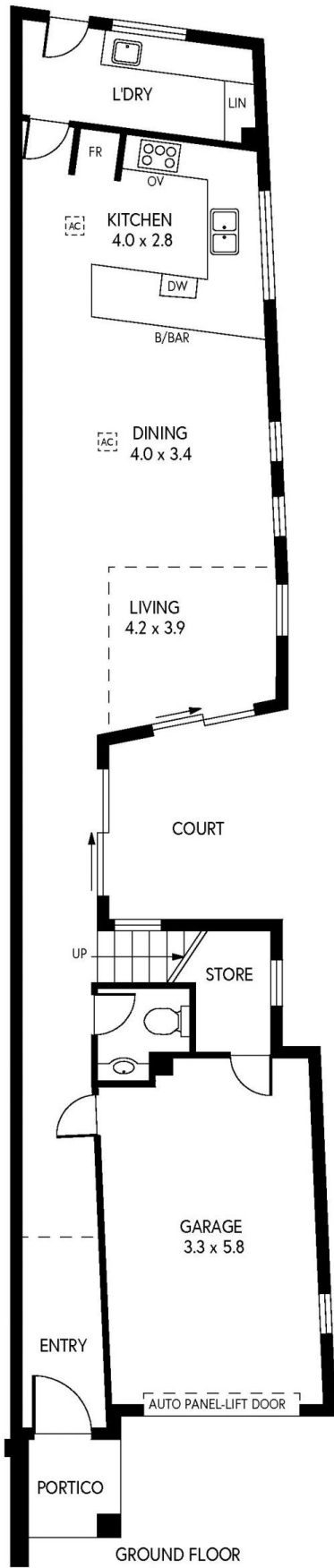

6A SYCAMORE TERRACE, CAMPBELLTOWN



INTERNAL - 211.1 SQM
 EXTERNAL - 2.7 SQM
 TOTAL - 213.8 SQM